

Wood Frame Installation

A typical wood frame including the liner is approximately 5 inches wide to properly cover the assembly. The wood overhangs the main shell approximately 3/4 inch when attached.

Two corner woods are attached to the backside of the wood frame to take-up the weight.

Two spring-loaded catches and a magnetic catch will hold the wood frame to the main shell. Simply snap the wood frame to the shell when ready.

Electrical Connections

A duplex AC outlet box is provided for 120VAC connection. Connect 120VAC to this box to power the TV and the IR remote control.

The Art Screen comes with IR remote control for operations. It is ready for use; no wiring connections are required.

Place the IR sensor so that it can be seen by the transmitter.

Plug the power cord to a 120VAC outlet.

The IR remote control has manual inputs for Home Automation systems, i.e. AMX, Crestron, etc. See IR remote control manual (included) for detail information.

The spring-loaded catch (Figure 3b) with SPDT switch may be used for security purpose; its contacts may be connected to an audible alarm system or monitoring system. The breach of security will be activated when the wood frame is removed.

The states of the contacts are shown when the Keeper is not engaged with the Catch.

Contact Rating: 6Amp, 250VAC or 3Amp, 30VDC.

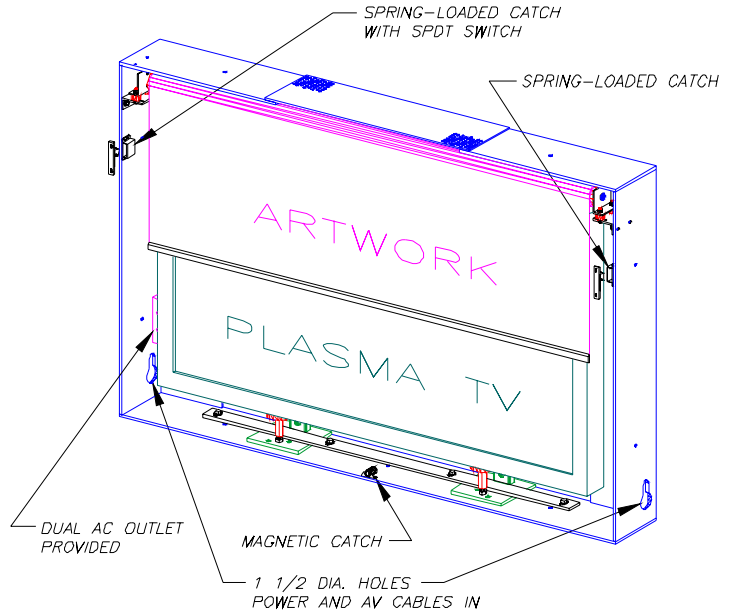

Figure 3a
Partial Assembly

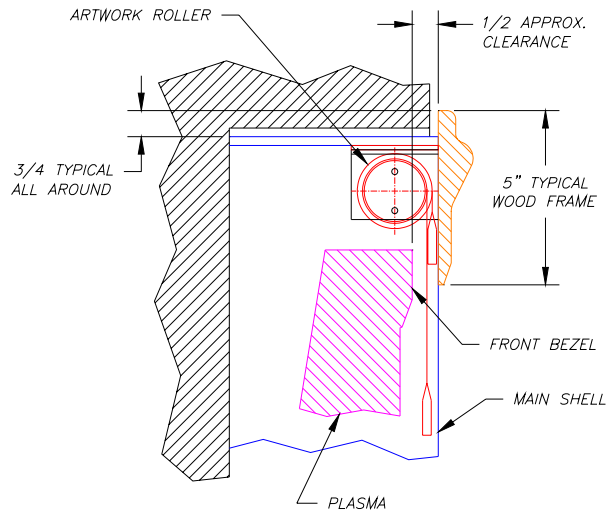

Figure 4
Side View

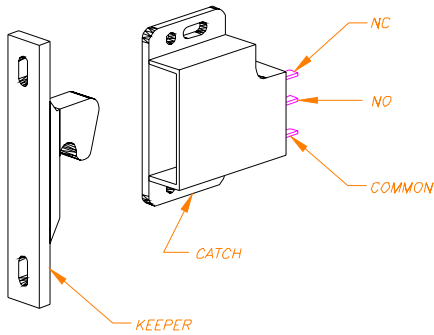

Figure 3b
Spring-loaded catch with SPDT switch



VUTEC CORPORATION
 (i) 2741 N.E. 4th Avenue
 Pompano Beach, FL 33064
 TEL: (954) 545 9000 - FAX: (954) 545 9011
 E-MAIL: info@vutec.com

Open and Close Limits Setting

The Open limit switch has been properly set for correct stop position. It should not be adjusted unless a change in the motor or the motor had been removed for service.

Note each full turn of the limit switch (360 degrees) causes the screen to travel approximately 1/2 inch.

1. **To lower the closed limit of the Art Screen.** Send the Art Screen down to its closed position. Turn the Close limit socket **counter-clockwise** (Figure 5); the Art Screen will advance downward as each full turn is made. Stop at the desired position.
2. **To raise the closed limit of the Art Screen.** Send the Art Screen down to its closed position. Determine the number of turns to stop the screen above the desired close limit. Turn the Close limit socket **clockwise** to raise the limit. The motor will not move for this direction.
3. Send the screen up halfway then stop. Send the screen down to its closed limit. The screen must stop above the desired position. If it is not, repeat step 2
4. When the Art Screen stopped above the desired closed limit; do Step 1 to set the desired closed limit.
5. Check and adjust the closed and open limits as necessary.

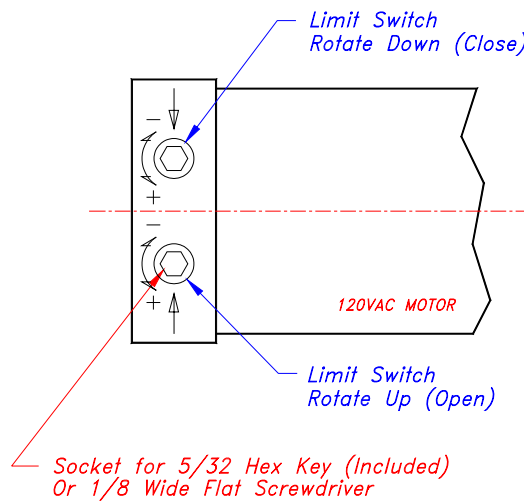

Figure 5
Motor Limit Switches



VUTEC CORPORATION
(i) 2741 N.E. 4th Avenue
Pompano Beach, FL 33064
TEL: (954) 545 9000 - FAX: (954) 545 9011
E-MAIL: info@vutec.com

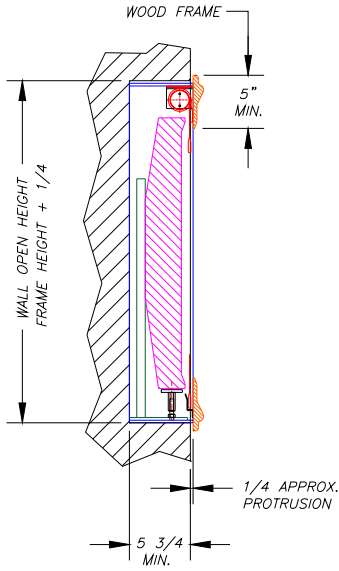

Figure 6a

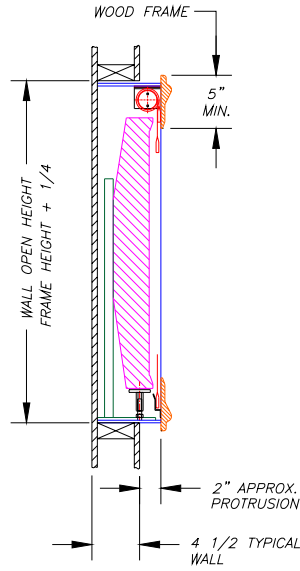

Figure 6b

40 and 50 inches Diagonal Plasmas

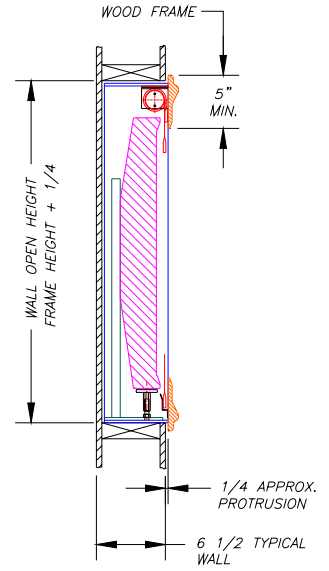

Figure 6c

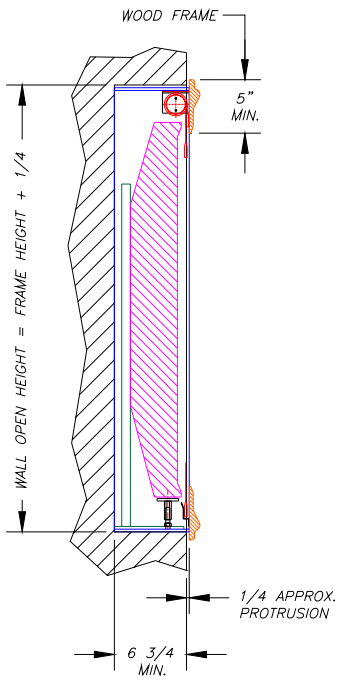

Figure 7a

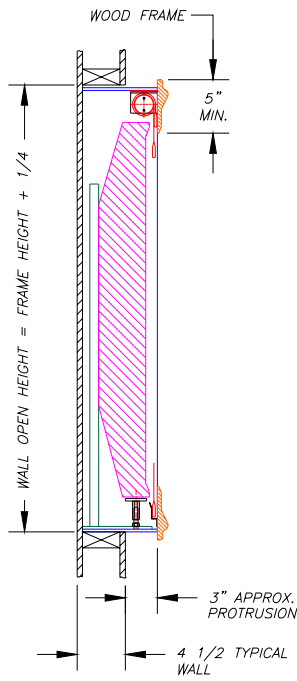

Figure 7b

60 inches Diagonal Plasma

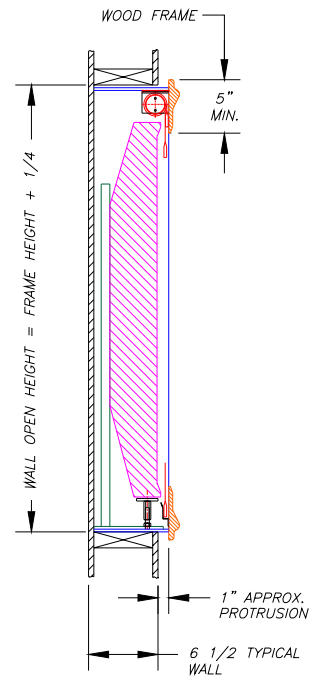

Figure 7c



VUTEC CORPORATION
 (i) 2741 N.E. 4th Avenue
 Pompano Beach, FL 33064
 TEL: (954) 545 9000 - FAX: (954) 545 9011
 E-MAIL: info@vutec.com

Accessories Included

<u>Description</u>	<u>QTY.</u>
Frame Assembly including Artwork and Motor	1
Plasma Stand Assembly	2
Clamp Bar	1
Wood Frame (Complete)	1
IR Receiver in Box	1
IR Sensor (6 Feet Long)	1
IR Transmitter	1
AAA Battery	2
#8 x 1 1/2 Long, Truss Head Phillip Screw	10
4mm x 12mm Long Button Head Cap Screw	4
6mm x 12mm Long Button Head Cap Screw	4
8mm x 12mm Long Button Head Cap Screw	4
3/16 Dia. Fender Washer	4
1/4 Dia. Fender Washer	4
5/16 Dia. Fender Washer	4
Limit Switch Setting Tool	1

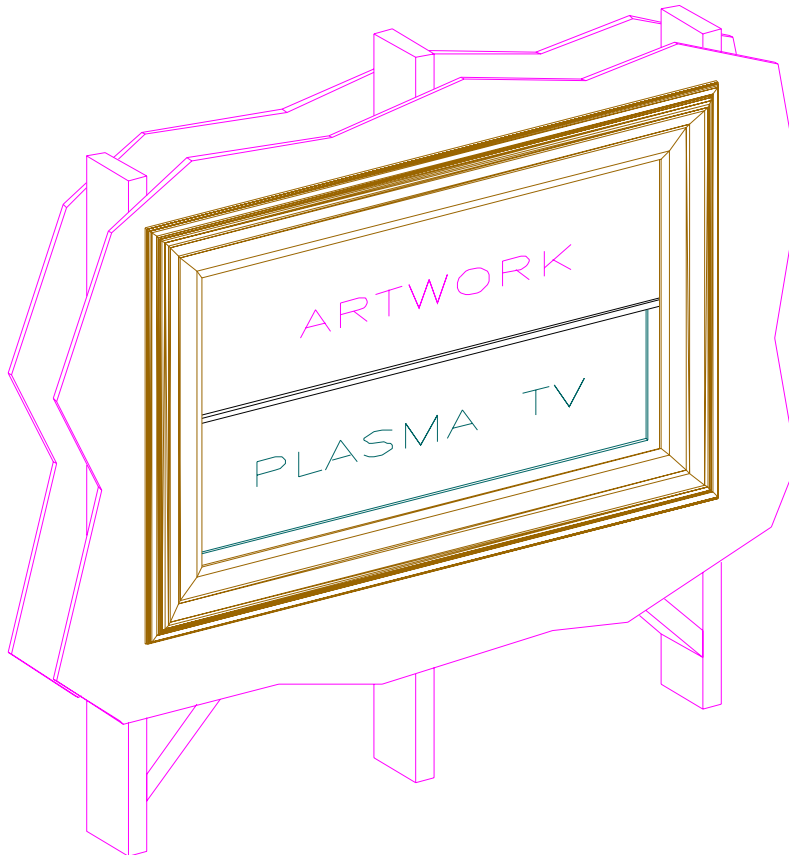

Figure 8
Complete Art Screen Installation



VUTEC CORPORATION
(i) 2741 N.E. 4th Avenue
Pompano Beach, FL 33064
TEL: (954) 545 9000 - FAX: (954) 545 9011
E-MAIL: info@vutec.com

WOOD FRAME INSTALLATION & REMOVAL

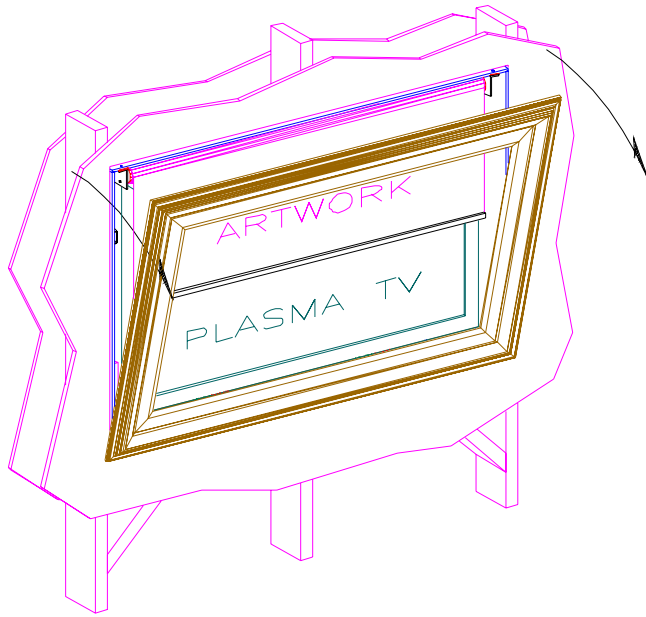

Figure A
Pull open the wood frame from the top

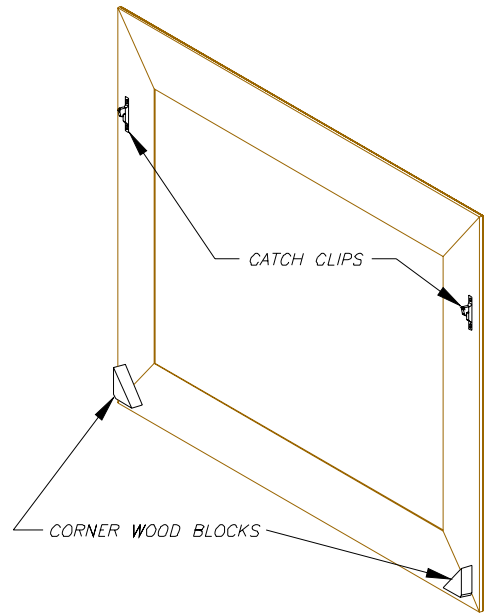

Figure B
Backside of wood frame

Note: Do not pull the wood frame straight out. The catches are designed to be separated in the peeling manner as shown in Figure A.

The Corner Wood Blocks are designed to carry the weight of the wood frame when installed. Carefully places them in the lower left and right corners of the artscreen frame before snapping the wood frame in place.

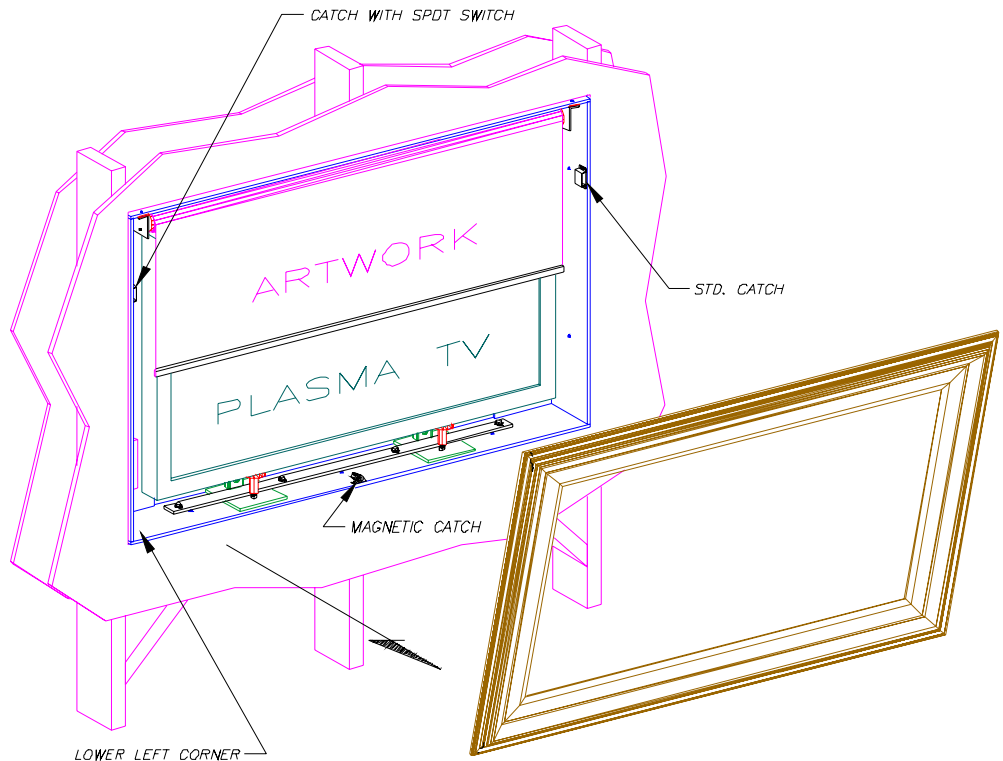

Figure C
Wood frame shown removed from Artscreen



VUTEC CORPORATION
(i) 2741 N.E. 4th Avenue
Pompano Beach, FL 33064
TEL: (954) 545 9000 - FAX: (954) 545 9011
E-MAIL: info@vutec.com

ART ROLLER INSTALLATION

Vutec has made a significant improvement to control and reduce the vibration noise level associated with the art roller motor.

The art roller motor is now shipped uninstalled to protect the four vibration dampers imparted in the design.

The following steps show how to install the art roller to the art screen unit.

Note: Installing the art roller motor must be the last thing to do! Therefore, the metal frame, the Plasma TV and its mounting location must have been installed, adjusted and checked to satisfaction before proceeding with the art roller installation.

- Step 1** Carefully remove the plastic wrapping. Locate two #8-32 machine screws and flat washers for used. There should be a layer of paper protecting the art roller. Do not remove the paper until the art roller has been installed and secured properly. The paper keeps the art print clean for final revelation.
- Step 2** Referring to Figure D, insert the art roller into the idler bracket at angle as shown. Rotates and guides the art roller into place such that it sits on the motor bracket as shown in Figure E.
- Step 3** Use #8-32 by 3/8 inch long machine screws to secure the art roller in place (Figure F). Do not over-tighten the screws.
- Step 4** No placement adjustments are necessary because the location of the idler bracket has been determined and it remained on the metal frame for this purpose.
- Step 5** Connect the motor cable to the IR control box.
- Step 6** Remove the masking tapes and the protective paper. The art roller is ready for operation!

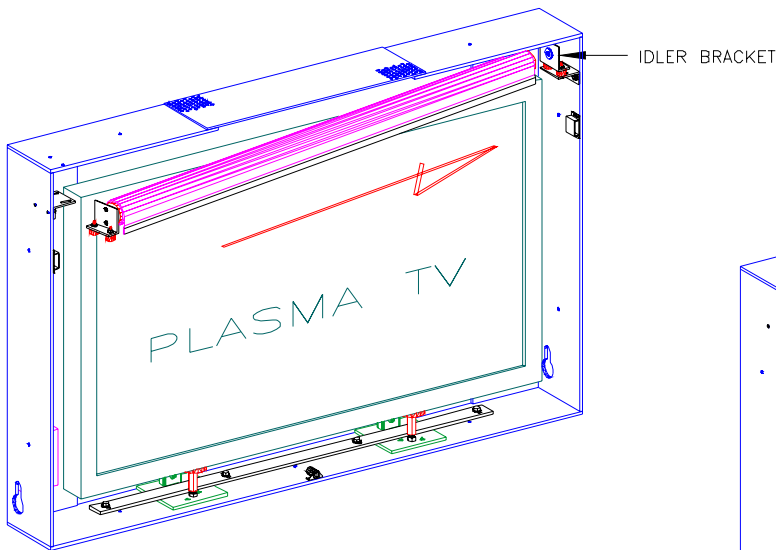

Figure D
Art roller insertion

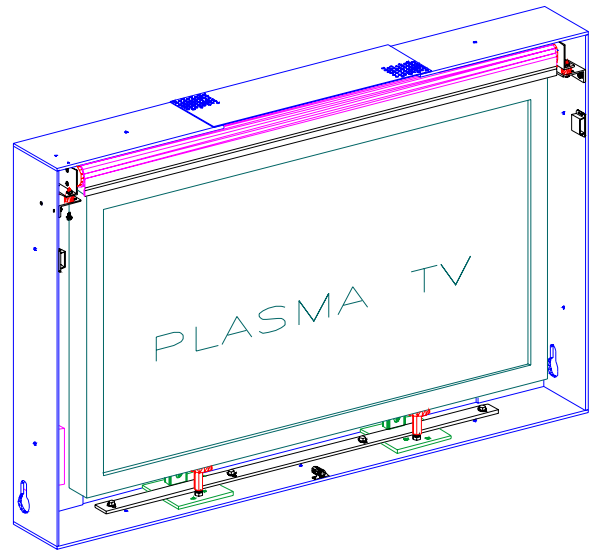
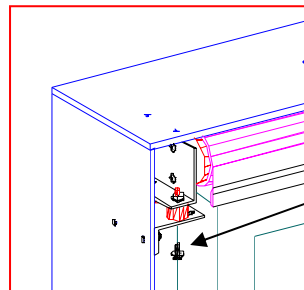

Figure E
Art roller in place



#8-32 x 3/8 long machine screw
2 required. Do not over-tighten.

Figure F
Screw attachment



VUTEC CORPORATION
(i) 2741 N.E. 4th Avenue
Pompano Beach, FL 33064
TEL: (954) 545 9000 - FAX: (954) 545 9011
E-MAIL: info@vutec.com