

PRISMATEC

Rear Projection Screen



With a gain of 5.0, **PrismaTec** is the brightest rear projection screen in the industry. **PrismaTec** offers sharp, vibrant pictures even in rooms with uncontrolled lighting and is an excellent choice for home theaters and commercial applications.

PrismaTec is available in fixed-frame or free-hanging systems, and is offered in 1:1, 4:3, 16:9 and 2.35:1 standard formats in a wide range of sizes.

FEATURES

- Non-coated Prismatic rear screen
- Excellent for home theater or commercial applications
- High gain (5.0)
- High contrast
- High ambient light rejection
- Custom sizes available
- Optional pre-assembled **SF Frame**
- Optional hanging systems available
- Custom sizes and formats available
- Available in 16:10 and 2.40:1 formats

TECHNICAL

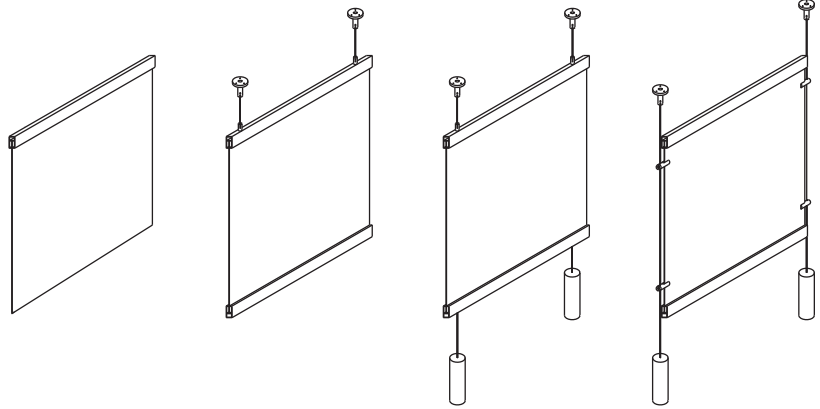

Diagonal	Viewing Area (nominal)	Shipping (nominal)
1:1 A/V Format		
n/a	40" x 40"	25 lbs.
n/a	50" x 50"	40 lbs.
n/a	60" x 60"	55 lbs.
n/a	80" x 80"	150 lbs.
4:3 Video Format		
50"	30" x 40"	20 lbs.
66"	40" x 53"	30 lbs.
84"	50" x 67"	50 lbs.
100"	60" x 80"	110 lbs.
120"	72" x 96"	160 lbs.
133"	80" x 106"	195 lbs.
16:9 HDTV Format		
92"	45" x 80"	85 lbs.
103"	50.5" x 89.75"	105 lbs.
110"	54" x 96"	125 lbs.
123"	60" x 107"	150 lbs.
133"	65" x 116"	175 lbs.
147"	72" x 128"	215 lbs.
2.35:1 Widescreen Format		
115"	45" x 105.75"	110 lbs.
129"	50.5" x 118.75"	140 lbs.
138"	54" x 127"	160 lbs.
153"	60" x 141"	180 lbs.

Custom sizes and formats are available.
(s) item is shipped on a skid.



The Projection Screen Technology Leader



P. 800.770.4700 / 954.545.9000
F. 800.548.5885 / 954.545.9011
www.vutec.com